

SPECIFICATIONS

AO Medium		TeO ₂
Acoustic Velocity		4.2 mm/μs
Active Aperture*	2.5 mm 'L' X	1 mm 'H'
Center Frequency (Fc)		80 MHz
RF Bandwidth	20 MHz @	-10 dB Return Loss
Input Impedance		50 Ohms Nominal
VSWR @ Fc		1.3 :1 Max
Wavelength		442-633 nm
Insertion Loss		4 % Max
Reflectivity per Surface		1 % Max
Anti-Reflection Coating		MIL-C-48497
Optical Power Density		250 W/mm ²
Contrast Ratio		1000 :1 Min
Polarization		90 ° To Mounting Plane

PERFORMANCE VS WAVELENGTH

Wavelength (nm)	442	488	515	633
Saturation RF Power (W)	.261	.318	.354	.534
Bragg Angle (mr)	4.2	4.6	4.9	6
Beam Separation (mr)	8.4	9.2	9.8	12

PERFORMANCE VS BEAM DIAMETER

Beam Diameter (μm)	200	300	400	500
at Wavelength (nm)	633	633	633	633
Diffraction Efficiency (%)	80	82	83	85
Rise Time (nsec)	41	57	72	88
Modulation Bandwidth	15.9	10.6	7.9	6.3
Beam Ellipticity	10	5	1	1

**For Reference
Only**

*Active Aperture: Aperture over which performance specifications apply.

Outline Drawing: Package AOMO 3080-110

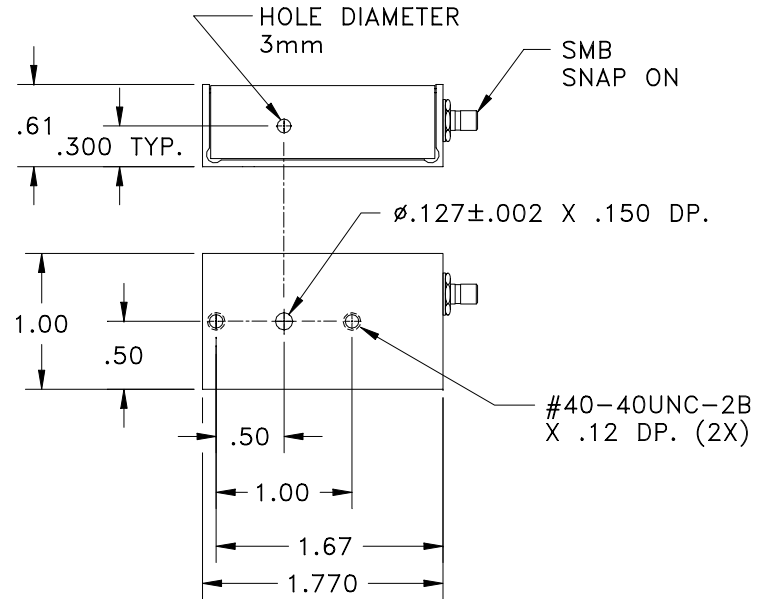

Notes:
Insertion Loss is 7% @ 442 - 458 nm.

THIS DOCUMENT IS THE PROPERTY OF CRYSTAL TECHNOLOGY, INC. IT IS NOT TO BE REPRODUCED OR DISCLOSED IN WHOLE OR IN PART OTHER THAN BY EMPLOYEES CRYSTAL TECHNOLOGY AND ITS CONTRACTED REPRESENTATIVES AND DISTRIBUTORS. ANY EXCEPTION REQUIRES THE WRITTEN CONSENT OF AN AUTHORIZED REPRESENTATIVE OF CRYSTAL TECHNOLOGY.

TOLERANCES: .XX ± .01 .XXX ± .005	DR	A. Campi 6/17/2002	Crystal Technology, Inc. DESCRIPTION: AOMO 3080-110
MATERIAL:	CHK		
FINISH:	APP		
	APP		PART NUMBER: 99-48201-10
			REV: C
			SHEET 1 OF 1