

4

3

2

1

NOTES: UNLESS OTHERWISE SPECIFIED

1. ALL SPECIFICATIONS ARE IN ACCORDANCE WITH MIL-O-13830.
2. MATERIAL: LITHIUM NIOBATE ($LiNbO_3$)
3. ORIENTATION: Z AXIS ± 10 ARC MINUTES TO END FACES. X AND Y AXIS TO X AND Y FACES ± 30 ARC MINUTES.
4. SURFACES MARKED [C] AND [D] TO BE POLISHED, ALL OTHERS AS-CUT OR GROUND.
5. CLEAR APERTURE: MINIMUM OF ENTIRE FACE MINUS A 0.5mm BORDER.
6. ENDS PARALLEL: < 10 ARC SEC.
7. END SURFACE FLATNESS (AT $.633\mu m$): $< OR = TO 1/8$.
8. END SURFACE QUALITY (SCRATCH-DIG): 10-5 OVER CLEAR APERTURE.
9. WAVE FRONT DISTORTION: $< OR = 1/8$ LAMBDA AT $.633\mu m$ IN THE CLEAR APERTURE (SINGLE PASS).
10. CHAMFER: $.010-.015$ " X 45° NOMINAL ALL EDGES.
11. COAT SURFACES MARKED [C] AND [D] PER MIL-C-675 OVER THE TEMPERATURE RANGE FROM -55° TO $+71^\circ C$, TYPE: ANTIREFLECTION, FOR LAMBDA = $1.064\mu m$ INCIDENT AT 0° , REFLECTANCE $< OR = .25\%$ PER SURFACE, DAMAGE THRESHOLD: $300 \times 10^6 W/CM^2$, 20NSEC NOM PULSEWIDTH.
12. ELECTRODE CONFIGURATION: TRANSVERSE MODE WITH SURFACES [A] AND [B] EVAPORATED GOLD, $2000^\circ A$ MINIMUM, 90% MINIMUM SURFACE COVERAGE.
13. EXTINCTION RATIO: 20dB OR BETTER AT $.633\mu m$.
14. INSERTION LOSS: $> 98\%$ SINGLE PASS TRANSMISSION @ $1064nm$.
15. MARK SURFACE [E] WITH AR COATING RUN NUMBER: A-BBBB
16. MARK SURFACE [F] WITH THE FOLLOWING INFORMATION:
 - a). CTI SOCN: 50559
 - b). CTI SERIAL NUMBER: SSSSS
 - c). ARROW TO IDENTIFY TESTED DIRECTION.

REVISIONS					
ZONE	REV	DESCRIPTION	ECO NO.	APPD.	DATE
ALL	0	INITIAL RELEASE	8869	NGO	01-27-97

D

D

C

C

B

B

A

A

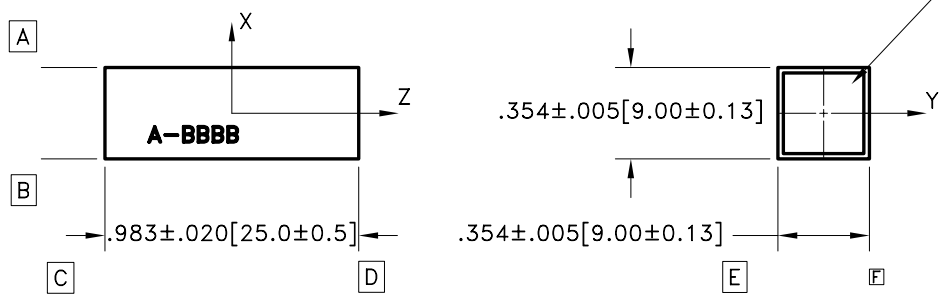

[5]

← 50559-SSSS

For Reference Only

THIS DOCUMENT IS THE PROPERTY OF CRYSTAL TECHNOLOGY, INC. IT IS NOT TO BE REPRODUCED OR DISCLOSED IN WHOLE OR IN PART OTHER THAN BY EMPLOYEES OF CRYSTAL TECHNOLOGY AND ITS CONTRACTED REPRESENTATIVES AND DISTRIBUTORS ANY EXCEPTION REQUIRES THE WRITTEN CONSENT OF AN AUTHORIZED REPRESENTATIVES OF CRYSTAL TECHNOLOGY.					
FINISH:	SEE NOTES	CONTRACT NUMBER			
MATERIAL:	[2.]	DR.	TOM-NGO	01-27-97	
SPEC. NO.	[2.]	CHK.			
UNLESS OTHERWISE SPECIFIED DIMENSIONS ARE IN IN [MM]		APPD.			
TOLERANCES		APPD.			
INCHES	MILLIMETERS	DESIGN ACTIVITY APPROVAL:			
.X ± .1	X ± 0.5	CUSTOMER APPROVAL:			
.XX ± .01	.X ± 0.1	SIZE	B	DWG. NO.	97-00970-03
.XXX ± .005	SURFACE FINISH	REV.	0	SH. 1 OF 1	
ANG ± .5	✓	DO NOT SCALE DRAWING		SCALE:	2:1

Crystal Technology, Inc.
A Siemens Company

TITLE: EQQS 7100-11A
300 MW/CM² DAMAGE THRESHOLD

4

3

2

1